

## PRODUCT DATASHEET

### PL-CUBE-AC-G3 -1100-830

PrevaLED® Cube AC G3 | Spot-, Down- and Wallmount Light Engines and Modules



#### Areas of application

- Suitable for diffuser and reflector luminaires
- Hospitality, hotels, restaurants
- Public and commercial buildings
- Offices
- Secondary rooms, garages, storerooms, cellars

#### Product benefits

- Enables low-cost and compact luminaire designs
- Low profile
- Future-proof dimensions for reliable designs
- Near Lambertian light distribution at 110° beam angle for high quality of light
- Protection against overheating due to thermal derating
- 5 year guarantee

#### Product features

- Mains voltage driven LED engine
- Integrated control gear
- Diameter of light emitting surface: 61 mm
- Common mechanic and photometric interfaces



- Initial color consistency: < 3 SDCM
- Lifetime (L70/B50): 50,000 h (temperature at  $T_c = 70\text{ °C}$ )
- LED module is reinforced isolated to mounting surface
- Photobiological safety according to IEC/TR 62778, risk group RG1

## TECHNICAL DATA

### Electrical data

Nominal wattage	11.30 W
Construction wattage	11.30 W
Nominal voltage	230 V
Input voltage range	220...240 V
Type of current	AC
Nominal current	50.000 mA
Power factor $\lambda$	> 0.90
Flickering metric (Pst LM)	$\leq 1$

### Photometrical data

Total useful luminous flux [PICOS]	1100 lm
Luminous efficacy	97 lm/W
Luminous flux	829 lm <sup>1)</sup>
Luminous intensity	403 cd
Nom. useful luminous flux 120° [PICOS]	879 lm
Flickering metric (Pst LM)	$\leq 1$
Color temperature	3000 K
Color rendering index Ra	> 80
Light color (designation)	Warm White
Standard deviation of color matching	3 sdcn
Rated peak intensity	403 cd
Lumen main.fact.at end of nom.life time	0.70
Stroboscope effect metric (SVM)	$\leq 0.9$

1) 120°

### Light technical data

Beam angle	110°
Rated beam angle (half peak value)	110.00°
Starting time	< 1.0 s
Warm-up time (60 %)	< 2.00 s

### LED MODULE INFORMATION

Number of LEDs per module	1
---------------------------	---

Dimensions & Weight

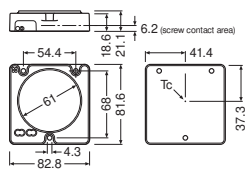

Length	82.80 mm <sup>1)</sup>
Width	81.60 mm
Height	21.10 mm
Product weight	59.4 g

1) general tolerances ISO 2768-c

Colors & materials

Product color	White
---------------	-------

Temperatures & operating conditions

Ambient temperature range	-20...+50 °C <sup>1)</sup>
Maximum temperature at tc test point	90 °C
Temperature range in operation	-20...+85 °C <sup>2)</sup>
Performance temp. acc. to IEC 62717	70 °C

1) T<sub>a</sub>(rated) = 25 °C

2) At the T<sub>C</sub> point

Lifespan

Nominal lamp life time	50000 h
Number of switching cycles	100000

Additional product data

Maximum thermal load	9.7 W
----------------------	-------

Capabilities

Dimmable	No
Dimming interface	DALI

## Certificates & Standards

Standards	CE / ENEC / CB VDE
Type of protection	IP20
Energy consumption	11.60 kWh/1000h
Energy efficiency class	F
Energy class of contained light source	F

## LOGISTICAL DATA

Temperature range at storage	-20...+85 °C
------------------------------	--------------



## Energy labelling regulation data acc EU 2019/2015

Lighting technology used	LED
--------------------------	-----

## ADDITIONAL PRODUCT INFORMATION

- Installation by qualified electrician only.
- Please see the relevant application guides and instructions sheets for more detailed safety and mounting information. Additional information is available on request.
- The module / light engine has to be mounted to a proper heat sink in order to ensure that the maximum rated temperature at the  $T_c$  point will not be exceeded.
- For safety reasons the LED light engine must not be operated if the housing is damaged.
- Complies with IEC/EN 62031
- Complies with IEC/EN 61547
- Complies with IEC/EN 61000-3-2
- Complies with EN 55015, CISPR 15
- Complies with IEC/EN 62717
- Suitable only for operation with line voltage.
- Parallel connection is mandatory for safe electrical operation. Serial connection of LED modules is strongly discouraged. Unbalanced voltage drop in serial connection can cause hazardous overload and damage the LED module.
- Conducting paths on the circuit board must not be damaged or destroyed during installation.
- Suitable for luminaires of protection class I, grounding is mandatory to comply with safety standards.
- When used in a luminaire of protection class II compliance with the required safety standards has to be ensured by the luminaire manufacturer.
- This LED module is not recommended to be used in rooms with fast moving parts as the light modulation can cause stroboscopic effects.
- This LED module might interfere with displays and cameras due to modulation.
- The LED module itself and all its components must not be stressed mechanically.
- For optimal cooling a thermal interface material should be applied between LED module and heat sink.
- It is highly recommended to use a thermal interface material (TIM). The TIM needs to enable adequate heat transfer, during installation it has to be taken care not to create air inclusions between surfaces. For this purpose it is recommended to use a heat sink with even and clean surfaces.
- The module must not be attached to wood or other flammable materials.
- Protect against splashes!
- The module, as manufactured, has no inherent protection against corrosion. It is the user's responsibility to provide suitable protection against corrosive agents, such as moisture, condensation and other harmful elements.

## DOWNLOAD DATA

Documents and certificates		Document name
	Declarations of conformity	664153_EC Declaration of Conformity: PL Cube AC G3
	Certificates	664159_ENEC VDE Certificate: PL Cube AC G3
	Certificates	664150_CB VDE Certificate: PL Cube AC G3

## LOGISTICAL DATA

Product code	Packaging unit (Pieces/Unit)	Dimensions (length x width x height)	Gross weight	Volume
4052899952690	Unpacked 1		59.40 g	
4052899953888	Shipping box 20	481 mm x 393 mm x 51 mm	1466.00 g	9.64 dm <sup>3</sup>

The mentioned product code describes the smallest quantity unit which can be ordered. One shipping unit can contain one or more single products. When placing an order, for the quantity please enter single or multiples of a shipping unit.

## References / Links

– For more information on the multi-level guarantee and the terms and conditions of the guarantee visit [www.ledvance.com/system-guarantee](http://www.ledvance.com/system-guarantee)

## DISCLAIMER

Subject to change without notice. Errors and omission excepted. Always make sure to use the most recent release.