

PRODUCT DATASHEET

PL-CORE-G7 3000-840 L15 H1

PrevaLED® Core G7 L15 H1 | Spot-, Down- and Wallmount Light Engines and Modules



Areas of application

- Spotlighting in shops and retail
- Down- and wall lighting in offices, corridors, meeting rooms, workplaces
- Decorative and functional lighting in hospitality, hotels, restaurants
- Functional lighting in public and commercial buildings

Product benefits

- Easy integration thanks to very compact form factor
- Easy cooling due to optimized efficiency and high maximum operation temperature
- High driver flexibility allows cost-effective and intelligent systems
- 5 year guarantee

Product features

- Complete portfolio with varying luminous flux, color temperature, color rendering
- Available with color temperature: 2,700 K, 3,000 K, 3,500 K or 4,000 K
- High module efficacy: up to 168 lm/W at $T_p = 65^\circ\text{C}$
- Lifetime (L80/B10): 60,000 h (temperature at $T_p = 65^\circ\text{C}$)
- LED module is basic isolated to mounting surface
- OEM Programmable with 1mA resolution to perfectly match LED load and maximize performance
- Max. working voltage: 60 V (to be operated only on SELV LED control gear)



TECHNICAL DATA

Electrical data

Nominal wattage	18.90 W
Construction wattage	18.90 W
Nominal voltage	34.8 V
Input voltage range	34...37 V
Type of current	DC
Nominal current	542.000 mA

Photometrical data

Total useful luminous flux [PICOS]	3000 lm
Luminous efficacy	159 lm/W
Luminous flux	3000 lm
Luminous intensity	1065 cd
Color temperature	4000 K
Color rendering index Ra	≥80
Light color LED	White
Light color (designation)	Neutral White
Standard deviation of color matching	≤3 sdcn
Rated peak intensity	1065 cd

Light technical data

Beam angle	120 °
Rated beam angle (half peak value)	114.60 °
Starting time	0.0 s
Warm-up time (60 %)	0.00 s

LED MODULE INFORMATION

Number of LEDs per module	1
---------------------------	---

Dimensions & Weight

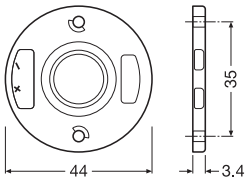

Length	44 mm
Height	3.40 mm
Diameter	44 mm
Product weight	6.00 g

Temperatures & operating conditions

Ambient temperature range	-20...+50 °C
Maximum temperature at tc test point	100 °C
Performance temp. acc. to IEC 62717	65 °C

Lifespan

Nominal lamp life time	60000 h
Number of switching cycles	100000

Additional product data

Product remark	Modules perfectly matched to OSRAM OPTOTRONIC® LED drivers (see relevant table) / For current photometric data and important safety, installation and application information, see www.osram.com/led-systems . / All the technical parameters apply to the entire module. In view of the complex manufacturing process for light emitting diodes, the typical values given above for the technical LED parameters are merely statistical values that do not necessarily correspond to the actual technical parameters of an individual product; individual products may vary from the typical values / Tolerance for optical and electrical data: +/- 10%
----------------	--

Capabilities

Dimmable	Yes
----------	-----



Certificates & Standards

Standards	CE / ENEC
Type of protection	IP20
Energy consumption	18.90 kWh/1000h
Energy efficiency class	A++

LOGISTICAL DATA

Temperature range at storage	-20...60 °C
------------------------------	-------------

DOWNLOAD DATA

Documents and certificates		Document name
	Addon technical information	PrevaLED Core Z7 Overview
	Declarations of conformity	Declaration of Conformity PL-CORE-G7
	Certificates	ENEC Certificate PL CORE z4 z5 z6 and z6 mini

LOGISTICAL DATA

Product code	Packaging unit (Pieces/Unit)	Dimensions (length x width x height)	Gross weight	Volume
4052899534520	Unpacked 1		79.00 g	
4052899535138	Shipping box 40	375 mm x 263 mm x 38 mm	807.00 g	3.75 dm ³

The mentioned product code describes the smallest quantity unit which can be ordered. One shipping unit can contain one or more single products. When placing an order, for the quantity please enter single or multiples of a shipping unit.

DISCLAIMER

Subject to change without notice. Errors and omission excepted. Always make sure to use the most recent release.