

PRODUCT DATASHEET

LS AY AC-CD P2 200 P

CONNECTOR FOR LED DRIVER | LED strip connector for LED driver connection

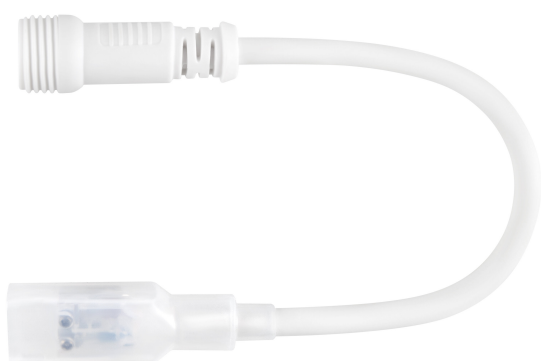

Areas of application

- General indoor illumination
- General outdoor illumination

Product benefits

- Easy installation of connector, no manual wiring required
- Simple and quick installation thanks to twist lock functionality

Product features

- Safe and professional connector of LED strips via integrated over-current protection (3.15A)
- Suitable for connection with LED driver DR P 500W 220-240V 215V P
- Type of protection: IP66

TECHNICAL DATA

Electrical data

| | |
|-----------------|----|
| Type of current | DC |
|-----------------|----|

Dimensions & Weight



| | |
|----------------|----------|
| Length | 300.0 mm |
| Width | 22.0 mm |
| Height | 20.0 mm |
| Product weight | 56.00 g |

Colors & materials

| | |
|---------------|--------------------|
| Product color | White |
| Body material | Polycarbonate (PC) |

Temperatures & operating conditions

| | |
|--|--------------|
| Ambient temperature range | -20...+45 °C |
| Temperature range in operation | -20...+45 °C |
| Permitted rel. humidity during operation | 0...93 % |



Additional product data



| | |
|----------------|-------------------------------|
| Product remark | Available from September 2024 |
|----------------|-------------------------------|

LOGISTICAL DATA

| | |
|------------------------------|--------------|
| Temperature range at storage | -20...+80 °C |
|------------------------------|--------------|

DOWNLOAD DATA

| Documents and certificates | | Document name |
|--|--|------------------------------------|
|  | User instruction / safety instructions | UI_LED STRIP_HV |
|  | Legal information | Informationstext 18 Abs 4 ElektroG |
|  | Legal information | Safety Insert G11201420 |

| Documents and certificates | | Document name |
|---|---------------------------------|---------------|
|  | Declarations of conformity | LS LUM |
|  | Declarations of conformity UKCA | LS LUM |

| Tender texts | | Document name |
|---|------------------|--------------------------------------|
|  | Tender documents | CONNECTOR FOR LED DRIVER P2 200 P-en |

LOGISTICAL DATA

| Product code | Packaging unit (Pieces/Unit) | Dimensions (length x width x height) | Gross weight | Volume |
|---------------|------------------------------|--------------------------------------|--------------|-----------|
| 4058075844742 | BAG 1 | 200 mm x 250 mm x 20 mm | 72.00 g | 1.00 dm³ |
| 4058075844759 | Shipping box 50 | 347 mm x 347 mm x 174 mm | 4093.00 g | 20.95 dm³ |

The mentioned product code describes the smallest quantity unit which can be ordered. One shipping unit can contain one or more single products. When placing an order, for the quantity please enter single or multiples of a shipping unit.

ADDITIONAL CATALOG INFORMATION

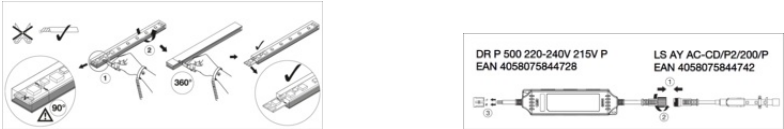

DISCLAIMER

Subject to change without notice. Errors and omission excepted. Always make sure to use the most recent release.