

# PRODUCT DATASHEET

## SP CBO RING FIX ROUND BK

SPOT COMBO RING FIX | Replaceable ring for SPOT COMBO FIX in round and square shape



---

### Product benefits

- Elegant design

---

### Product features

- Available in round and square shape
- Available in three different colors: white, black and brushed nickel
- Material: aluminum



## TECHNICAL DATA

### Dimensions & Weight

Diameter	81.5 mm
Height	3.7 mm
Product weight	18.00 g

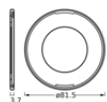

SP COV RING FIX ROUND BN

### Materials & Colors

Product color	Black
Body material	Aluminum

### Application & Mounting

Ambient temperature range	-20...+40 °C
Mounting location	Luminaire
Replaceable light source	No



### Certificates & Standards

Standards	CE / UKCA
-----------	-----------

### Safety advice

- Check wall-ceiling for suitability. If uncertain, seek professional advice.

## DOWNLOAD DATA

Documents and certificates		Document name
	User instruction / safety instructions	UI SPOT COMBO and ACC
	Declarations of conformity	CE Declaration SP COMBO

Documents and certificates		Document name
	Declarations of conformity UKCA	UKCA Declaration SP COMBO

Tender texts		Document name
	Tender documents	SPOT COMBO RING FIX FIX ROUND BK-EN

LOGISTICAL DATA

Product code	Packaging unit (Pieces/Unit)	Dimensions (length x width x height)	Gross weight	Volume
4099854098406	BAG 1	5 mm x 80 mm x 80 mm	20.00 g	0.03 dm³
4099854098413	Shipping box 20	125 mm x 95 mm x 95 mm	460.00 g	1.13 dm³
4099854098420	Shipping box 240	300 mm x 264 mm x 216 mm	5857.00 g	17.11 dm³

The mentioned product code describes the smallest quantity unit which can be ordered. One shipping unit can contain one or more single products. When placing an order, for the quantity please enter single or multiples of a shipping unit.

DISCLAIMER

Subject to change without notice. Errors and omission excepted. Always make sure to use the most recent release.