

PRODUCT DATASHEET

DALI-2 SENSOR LS/PD O CI

DALI-2 SENSOR LS-PD O CI | Sensors for wired IOT Light management systems with DALI-2 technology



Areas of application

- Open offices
- Indoor navigation
- Conference rooms
- Classrooms
- Storage and break areas
- Stairways
- Sanitary areas

Product benefits

- Large motion detection range
- Simple and fast installation via wire springs
- DALI-2 certified
- DALI Bus powered (No mains connection necessary)
- Multiple sensors connectable to the same DALI line
- Shutter included to optimize sensor detection
- Integretable in light- and building management systems supporting DALI-2 sensors

Product features

- Light and presence sensor for ceiling integration
- Presence detection via passive IR element
- Light sensor operating range: 5...2000 lx (measured at sensor)
- Detection height up to 4 meter
- Function indicator LED

TECHNICAL DATA

Electrical data

Nominal wattage	0.10 W
Nominal voltage	16 V
Mains frequency	0 Hz

Dimensions & Weight

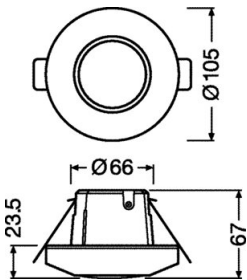

Length	105.00 mm
Mounting hole spacing, length	68.00 mm
Width	105.00 mm
Height	67.00 mm
Diameter	105.00 mm
Product weight	120.00 g

Colors & materials

Product color	Light grey
---------------	------------

Temperatures & operating conditions

Ambient temperature range	-20...+45 °C
---------------------------	--------------

Capabilities

Dimmable	No
Dimming interface	DALI-2
Maximum installation height	4 m
Detection area	12 m ²
Detection angle	360 °
Type of installation	Ceiling integration
Operating range, light sensor	5...2000 lx



Certificates & Standards

Approval marks – approval	CE / UKCA
Protection class	II
Type of protection	IP20

EQUIPMENT / ACCESSORIES

- Optional: Surface mounting via QBM 220-240 LS/PD CM KIT
- Optional: IP54 with Surface mounting KIT

DOWNLOAD DATA

Documents and certificates		Document name
	User instruction / safety instructions	DALI-2 SENSOR LS/PD
	Declarations of conformity	DALI-2 SENSOR LS/PD
	Declarations of conformity UKCA	DALI-2 SENSOR LS/PD

LOGISTICAL DATA

Product code	Packaging unit (Pieces/Unit)	Dimensions (length x width x height)	Gross weight	Volume
4052899630444	Folding box 1	123 mm x 123 mm x 95 mm	230.00 g	1.44 dm ³
4052899630499	Shipping box 24	525 mm x 390 mm x 215 mm	6340.00 g	44.02 dm ³

The mentioned product code describes the smallest quantity unit which can be ordered. One shipping unit can contain one or more single products. When placing an order, for the quantity please enter single or multiples of a shipping unit.

DISCLAIMER

Subject to change without notice. Errors and omission excepted. Always make sure to use the most recent release.