

# PRODUCT DATASHEET

## SMART+ TIBEA Pendant

TIBEA CEILING E27 | Indoor luminaires, E27 socket



---

### AREAS OF APPLICATION

- General illumination
- Living areas (living rooms, dining rooms, bedrooms etc.)
- Professional (hotels, bars, boutiques etc.)
- Suitable for lamps with E27 base

---

### PRODUCT BENEFITS

- Stylish and modern design
- Easy to install and use
- High flexibility in the choice of the light source thanks to E27 base

---

### PRODUCT FEATURES

- Retro design
- As ceiling, pendant and mini type-version available



## TECHNICAL DATA

### Electrical data

<b>Nominal voltage</b>	220...240 V
<b>Mains frequency</b>	50/60 Hz

### Dimensions & weight

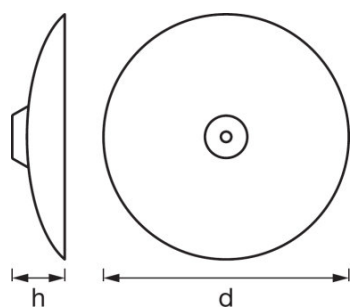

<b>Product weight</b>	600.00 g
<b>Height</b>	69.0 mm
<b>Diameter</b>	350.0 mm

### Colors & materials

<b>Product color</b>	White
<b>Body material</b>	Aluminum
<b>Housing color</b>	White

### Temperatures & operating conditions

<b>Ambient temperature range</b>	-20...+40 °C
----------------------------------	--------------

### Capabilities

<b>Holder designation</b>	E27
<b>Dimmable</b>	No
<b>Type of connection</b>	Terminal, 2-Pole (L, N)

### Certificates & standards

<b>Standards</b>	CE
<b>Type of protection</b>	IP20
<b>Energy clas. of compatible lamps</b>	A++/A+/A/B/C/D/E

---

**EQUIPMENT / ACCESSORIES**

– TIBEA style lamps can be combined with these luminaires

---

**LOGISTICAL DATA**

Product code	Packaging unit (Pieces/Unit)	Dimensions (length x width x height)	Gross weight	Volume
4058075168695	Folding carton box 1	361 mm x 465 mm x 109 mm	1048.00 g	18.30 dm <sup>3</sup>
4058075168701	Shipping carton box 2	570 mm x 460 mm x 230 mm	3772.00 g	60.31 dm <sup>3</sup>

The mentioned product code describes the smallest quantity unit which can be ordered. One shipping unit can contain one or more single products. When placing an order, for the quantity please enter single or multiples of a shipping unit.

---

**DISCLAIMER**

Subject to change without notice. Errors and omission excepted. Always make sure to use the most recent release.