

## PRODUCT DATASHEET

### LUXeye Sense 10A BT

LUXeye Sense 10A BT | Light management systems



#### AREAS OF APPLICATION

- Offices
- Conference rooms
- Training rooms
- Corridors
- Surface mounting via LUXeye SENSE CM KIT

#### PRODUCT FAMILY BENEFITS

- Automatic start of light regulation after power-on (out of the box function)
- Basic functionality without configuration thanks to applied pre-settings
- Easy and fast customization of important parameter via screwdriver
- $V(\lambda)$  corrected light sensor element
- Predefined and customizable configurations for all applications
- Password protection for user and configuration APP access
- Easy report generation of all commissioned sensors
- Easy report sharing via email
- DEMO Mode usable without device

#### PRODUCT FAMILY FEATURES

- 10 A output relay for ohmic, inductive and capacitive load
- Daylight-dependent switching and presence-dependent control of light
- Operation via standard pushbutton
- Outputs with electronical reversible short-circuit and overload protection
- Change of delay time with screwdriver direct at the sensor
- Change of switch off level with screwdriver direct at the sensor
- Halogen free polycarbonate plastic housing
- Controller with integrated light and presence sensor, relay, Bluetooth interface

- Presence detection via passive IR element
- Light control via smart phone
- Adjustment of all settings via smartphone
- Function indicator with three color LED
- Individual activation and deactivation of light and presence sensor
- Various shutters included for different detection areas

**TECHNICAL DATA**

Electrical data

<b>Nominal voltage</b>	220...240 V
<b>Mains frequency</b>	50...60 Hz
<b>System wattage [AGGR]</b>	0.40 W

Dimensions & weight

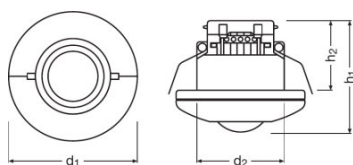

<b>Diameter</b>	95.0 mm
<b>Width</b>	90.0 mm
<b>Height</b>	81.0 mm
<b>Product weight</b>	157.00 g

Colors & materials

<b>Product color</b>	White
----------------------	-------

Temperatures & operating conditions

<b>Ambient temperature range</b>	0...+55 °C
----------------------------------	------------

Capabilities

<b>Dimmable</b>	No
<b>Dimming interface</b>	-
<b>Transmitter range</b>	15 m
<b>Maximum installation height</b>	5 m
<b>Detection area</b>	10 m <sup>2</sup>

<b>Detection angle</b>	110 °
<b>Load contact</b>	10 A
<b>Type of installation</b>	Ceiling integration
<b>Operating range, light sensor</b>	20...5000 lx <sup>1)</sup>

<sup>1)</sup> Approximately, measured at the sensor

### Certificates & standards

<b>Type of protection</b>	IP20
---------------------------	------

### Wiring Diagram

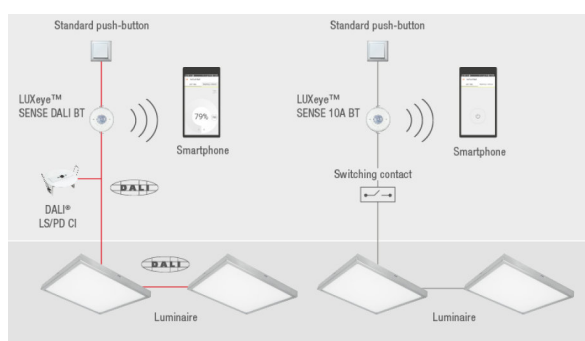



### Wiring diagram

### EQUIPMENT / ACCESSORIES

- Free App for iOS and Android
- Suitable for 10 A R/L/C load similar to 10 A fuse (B)

### DOWNLOAD DATA

File
 User instruction 728510_LUXeye Sense 10A BT User Instruction
 Declarations of conformity 727945_Declaration of conformity LUXeye Sense
 Declarations of conformity 9C1-3433399-EN-01 LUXEYE SENSE (EN)

---

**LOGISTICAL DATA**

Product code	Packaging unit (Pieces/Unit)	Dimensions (length x width x height)	Gross weight	Volume
4052899957428	Folding carton box 1	160 mm x 125 mm x 90 mm	256.00 g	1.80 dm <sup>3</sup>
4052899957466	Shipping carton box 12	495 mm x 265 mm x 192 mm	3069.00 g	25.19 dm <sup>3</sup>

The mentioned product code describes the smallest quantity unit which can be ordered. One shipping unit can contain one or more single products. When placing an order, for the quantity please enter single or multiples of a shipping unit.

---

**DISCLAIMER**

Subject to change without notice. Errors and omission excepted. Always make sure to use the most recent release.